

SPECIFICATIONS:



	SMS110	SMS120	SMS122
RANGE	0.0 to 14.0 pH		
RESOLUTION	0.1 pH		
ACCURACY (@25°C)	±0.2 pH		
SETPOINT	3.5 to 7.5 pH	5.5 to 9.5 pH	
ALARM	active when measure is higher than selected setpoint		
OUTPUT POWER SOCKET	active when measure is higher than selected setpoint (5A max)		
(for SMS122 only)			
POWER DRIVERS	115VAC, 2A, 60Hz or 230VAC, 1A, 50Hz		
(for SMS122 only)			
pH ELECTRODE	MA911B/1 (included)		
ENVIRONMENT	0 to 50°C, 95% RH not condensing		
POWER SUPPLY	12 VDC (included)		
DIMENSIONS	160 x 80 x 40 mm		
WEIGHT	220 g (meter only)		

OPTIONAL ACCESSORIES:

M10004B	pH 4.01 buffer solution, 20 ml sachet (25 pcs)
M10007B	pH 7.01 buffer solution, 20 ml sachet (25 pcs)
M10010B	pH 10.01 buffer solution, 20 ml sachet (25 pcs)
M10000B	Electrode rinse solution, 20 ml sachet (25 pcs)
MA9015	Electrode storage solution, 20 ml sachet (25 pcs)

WARRANTY:

These instruments are warranted from all defects in materials and manufacturing for a period of **two years** from the date of purchase. The electrode is warranted for a period of **6 months**.

If during this period, the repair or replacement of parts is required, where the damage is not due to negligence or erroneous operation by the user, please return the parts to either dealer or our office and the repair will be effected free of charge.

Note: We reserve the right to modify the design, construction and appearance of our products without advance notice.



USER MANUAL

PORTABLE pH METER

MODELS: SMS110 - SMS120 - SMS122

Smart Monitoring System

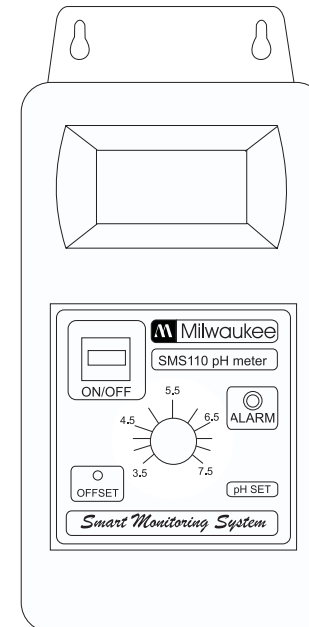

OPERATION:

- Connect the supplied 12VDC power adapter to the meter and to the mains line.
- Connect the pH-electrode to the BNC socket on the bottom of the meter.
- Always remove the electrode protective cap before taking any measurement. If the electrode has been left dry, soak the tip (bottom 2.5 cm) in M10000B rinse solution for a few minutes to reactivate it.
- Make sure that the meter has been calibrated before taking any measurements (see Calibration Procedure).
- Immerse the tip (2.5 cm) of the pH-electrode into the sample.
- Turn the instrument on by pressing the ON/OFF key.
- Allow the reading to stabilize and the meter will start continuous monitoring.
- A blinking alarm will indicate when the measured pH value is higher than selected setpoint.

NOTE: The output power contact (SMS122 only) has no protection fuse inside the meter. It is recommended to protect it outside, against failure.

SETPOINT:

- The setpoint can be selected by adjusting the central front knob to the desired value.
- The selectable range is from 3.5 to 7.5 pH for SMS110; from 5.5 to 9.5 pH for SMS120 and SMS122.

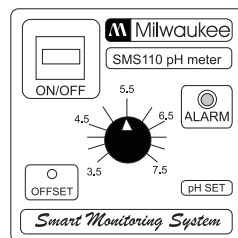
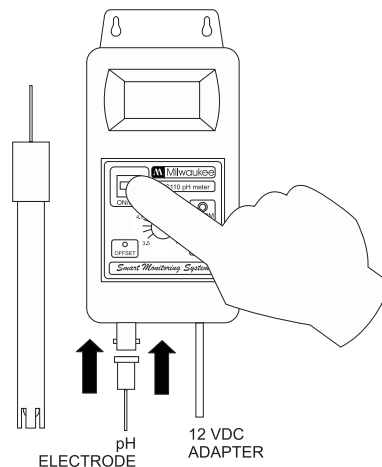

CALIBRATION PROCEDURE:

- Remove the protective cap from the electrode.
- Immerse the electrode tip into a new sachet of pH 7 calibration solution and allow the reading to stabilize.
- Adjust the OFFSET calibration trimmer (on the front) to display "7.0 pH".
- Open a new sachet of pH 4 calibration solution and use a small quantity to rinse the electrode.
- Immerse the electrode tip into the pH 4 sachet and allow the reading to stabilize.
- Adjust the SLOPE calibration trimmer (on the rear) to display "4.0 pH".
- The calibration is now complete and the meter is ready to take measurements.
- It is suggested to recalibrate the meter at least once a month, after a prolonged stocking time and after pH-electrode replacement.



INSTALLATION PROCEDURE:

(for SMS122 only)

